

the wonderpass

Mission: Redefine the US-190 underpass as a softened portal that encourages community interaction and connectivity through vegetation, natural materials, and interactive light.

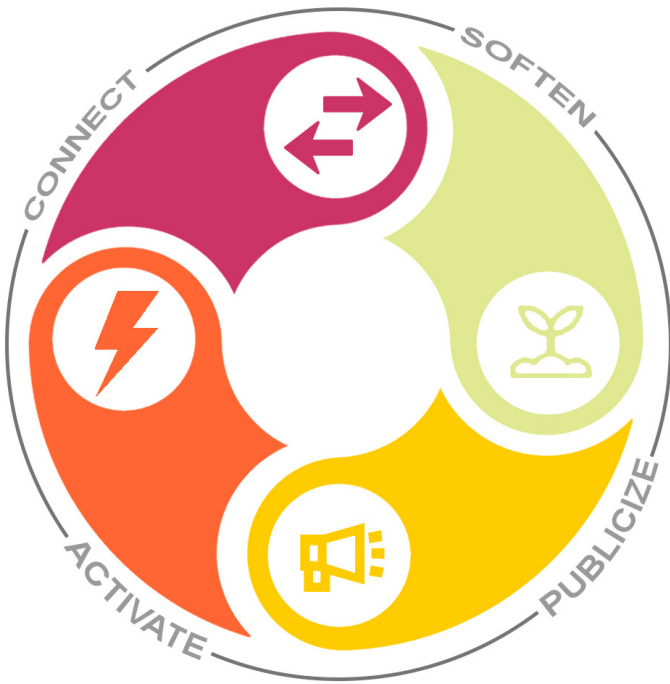

Existing Site Conditions:



Constraints	Proposed Solutions	Goals
- Space divided in half by North and South Main Street	→ Create connections from one side to the other	
- Intersected by I-14/Hwy 190 going East and West	→ Design to their scale and try to get drivers to t over	
- Steep Concrete Ramps and Slope	→ Use this to create a unique feature for the city	
- No crosswalks	→ Implement crosswalks	

Inspirational Photos:

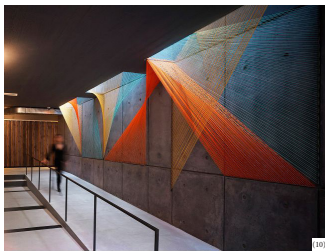

Constraints	Proposed Solutions	Goals
- Concrete Sidewalks	→ Turn into a bike lane and add a pedestrian trail	
- Concrete Columns	→ Paint bright colors, add murals, and lights	
- Sparce Vegetation	→ Add trees, grasses, wildflowers, and gardens	
- Eroded Soil	→ Add native vegetation	

Stakeholder Perspectives:

City
Official

Is this within our budget and what demographic are you catering to?

- Our goal is to provide you with unique designs that you might not have seen before. The final solution can be implemented into phases in order to meet your specified budget.
- We are hoping that all residents of Nolanville will use the underpass as a gateway from one side of town to the other.

Parent

Will my kids be safe walking under the underpass?

- Yes. We are incorporating crosswalks, sidewalks, clear sight-lines, no hidden spaces, and lighting. There will be crosswalks on all four corners of the intersection along with stop lights going north to south and stop signs from east to west. This will allow residents to safely cross the road and be directed to our designated pedestrian pathways and bike lanes.

Committee
Member

Is there going to be a unique lighting and will it affect pollinator species? Also, how much maintenance will this require?

- Yes. We are each creating our own lighting design layout which will include a variety of perspectives to exhibit our design. This will get you a few options to choose from
- No, We are using non UV lights.

Visitor

Why would someone want to hang out under and underpass and will the grasses be home to snakes?

- Our goal isn't to create a gathering space but instead provide connectivity, encourage creative discussion, and serve as a way-finding component.
- No. The space is very confined and loud causing it to be a terrible habitat for critters.

Stakeholder Perspectives:

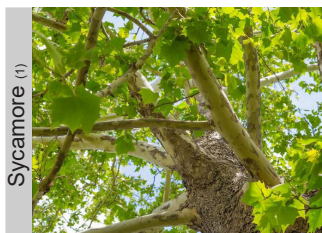
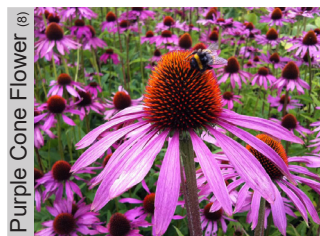
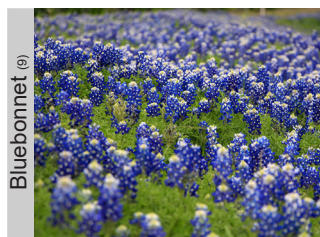

Proposed Solutions



the wonderpass

Connect the Unconnected

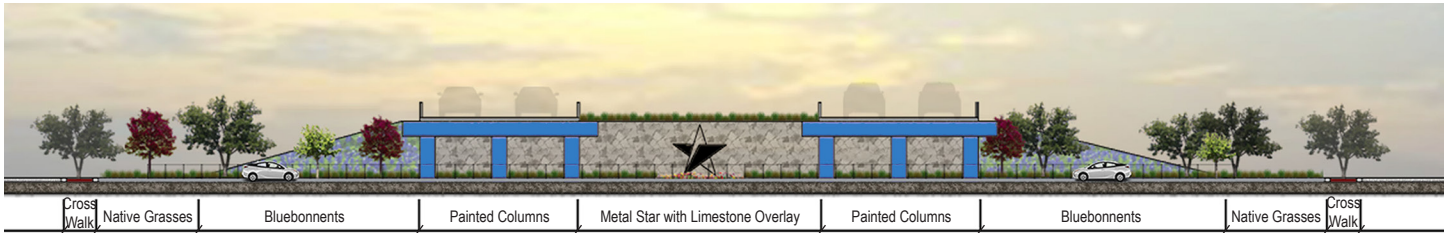

Connect

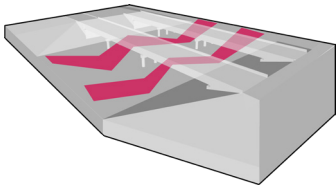

- Pedestrian Trail and Bike Path that connect to both sides of the road
- Cross walks at both intersections
- Multi-purpose trail lining both feeder roads

Soften

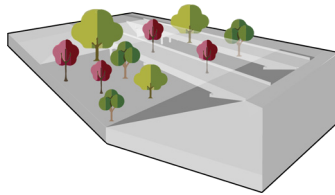

- Sycamores, Pecans, and Red Maples scattered throughout the site
- Butterfly Garden with bright colored flowers
- Native grasses and wildflowers

Publicize

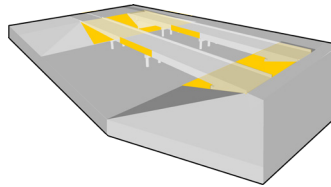

- Limestone overlay with custom, metal Nolanville star
- 'Welcome to Nolanville' and 'A Great Place to Live' painted on overpass

Activate

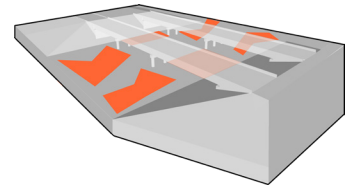

- Butterfly garden with benches to encourage gathering
- Trail system that connects the entire site with the rest of the city

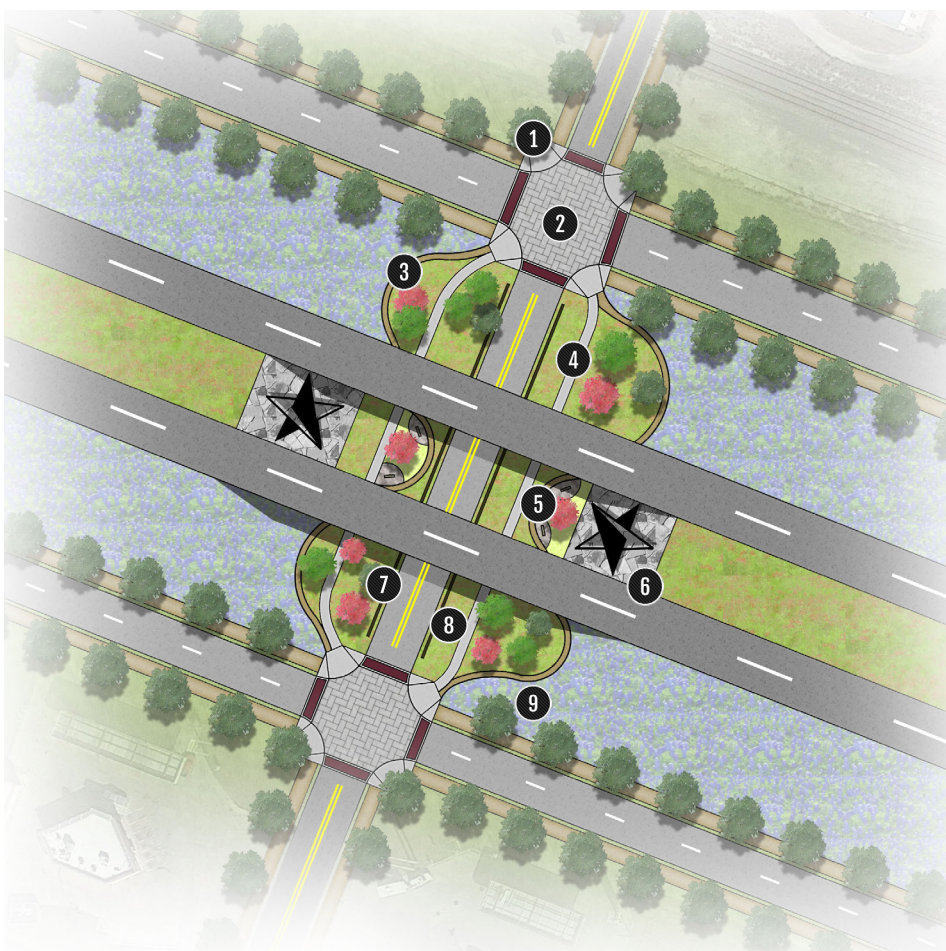

Legend

1. DG Multi-Purpose Trail and Street Trees



2. Brick Paver Intersection with Painted Crosswalks



3. DG Pedestrian Trail



4. Existing Concrete Sidewalk turned into a Bike Path



5. Butterfly Garden with colorful flowers and benches



6. Metal Star on Limestone Overlay



7. Rustic Fence Rail



8. Native Grasses



9. Bluebonnets/Wildflowers





Butterfly Garden inbetween Underpass



Connection of the variety of trails at the Underpass

the wonderpass

Nolanville Underpass

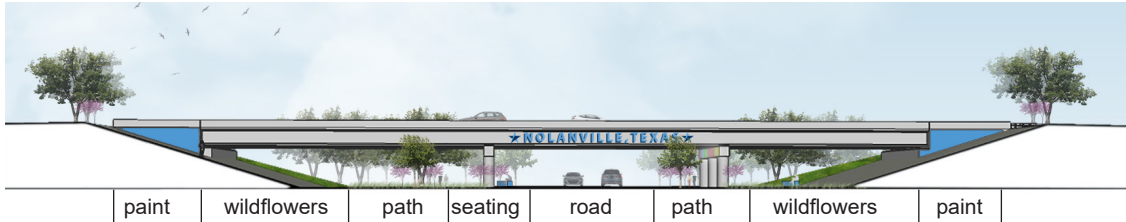

Connect

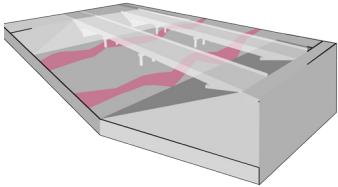

- Pedestrian Trail and Bike Path that connect to both sides of the road
- Cross walks at both intersections

Soften

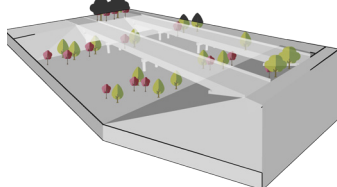

- Sycamores, Pecans, and Red Maples scattered throughout the site
- Native grasses and wildflowers
- Grass mounds and DG

Publicize

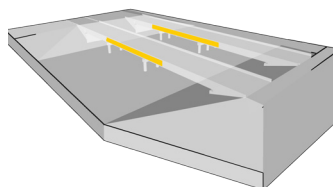

- Nolanville Painting
- Colored Seating

Activate

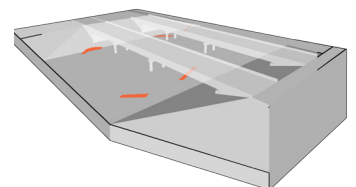

- Grass mounds and rest areas
- Seating



Legend

- | | |
|------------------------------|--|
| 1. Brick Paver Intersection | |
| 2. Seating | |
| 3. Art/Loal Installation | |
| 4. Wildflower Planting | |
| 5. Decomposed Granite Trail | |
| 6. Grass mounds and planting | |
| 7. Bike Path | |
| 8. Shade/Street Trees | |



View of Underpass Planting



View Beneath Overpass

the wonderpass

the Activated Grove

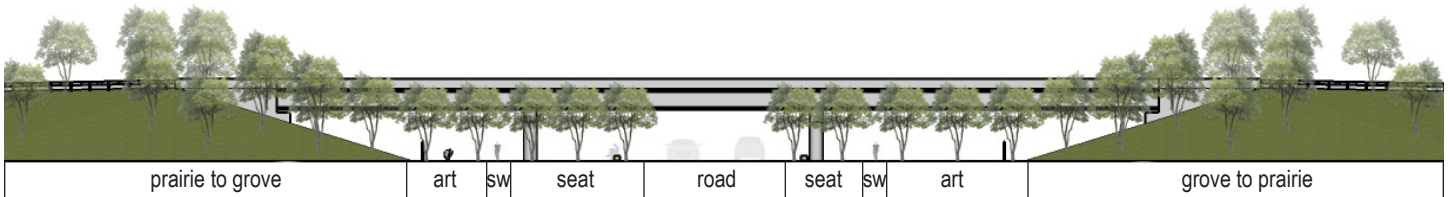

Connect

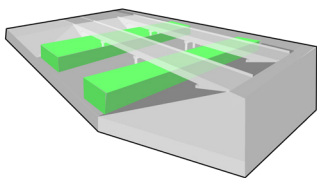

The elm grove marches through the underpass, visually and experientially stitching the cleft of the highway on Nolanville's cultural and physical landscape.

Soften

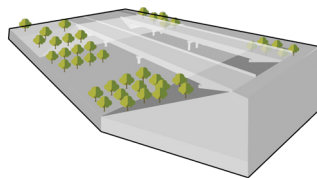

The grove's canopy reaches up, softening the hard lines of the highway overpass. At eye-level, the horizontal barrier dissolves as the rigid grove dissolves into the native grasses flanking the highway.

Publicize

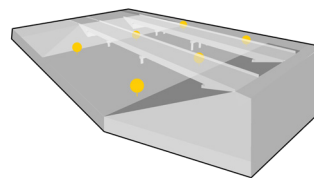

Tucked into the grove are six opportunities for public installation art, adding interest to an otherwise one-dimensional space. This gives the community an opportunity to take ownership of the throughway.

Activate

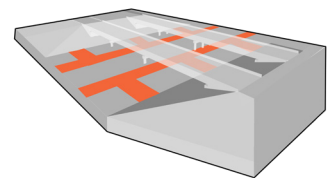

Intentionally-placed, offset pockets designate the underpass as a place for public activity and engagement - even if in passing. This increases safety and suggests that community contributions are a priority.

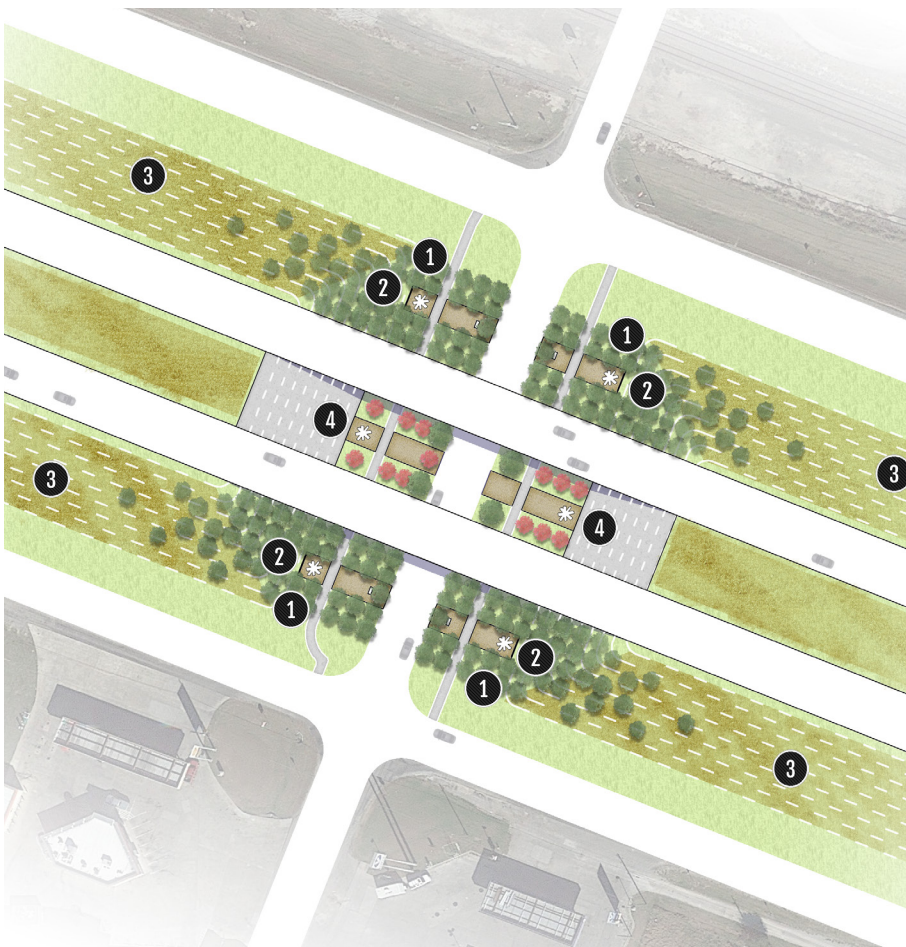

Legend

1. Elm grove flanking existing sidewalk



2. DG art cove straddling sidewalk with brick free-standing background and quarry block limestone seat.



3. Seeded native Blackland Prairie grasses feathered into area of interest



4. DG art cove with greater potential for permanent/semi-permanent light-based installations. The grove thins here and is supplemented with accent redbuds.





Southside grove and art cove



Under the underpass looking south

the wonderpass

Vertical Outreach

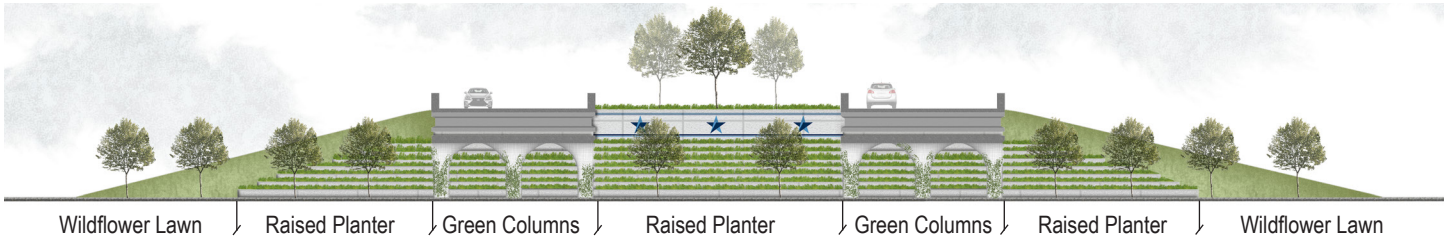

Wildflower Lawn

Raised Planter

Green Columns

Raised Planter

Green Columns

Raised Planter

Wildflower Lawn

Connect

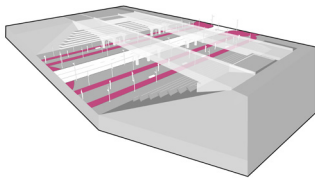

- Pedestrian Trail and Bike Path that connect to both sides of the road
- Cross walks at both intersections
- Crosswalk at both intersections

Soften

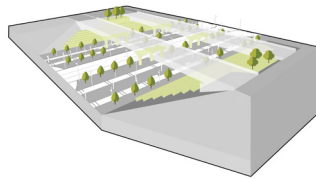

- Sycamores, Pecans, and Red Maples scattered throughout the site
- Raised Vertical Planters
- Native grasses and wildflowers

Publicize

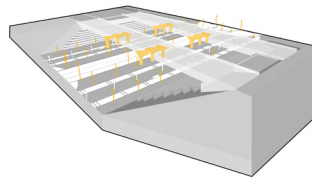

- Startigic Lighting
- Nollanville Branding

Activate

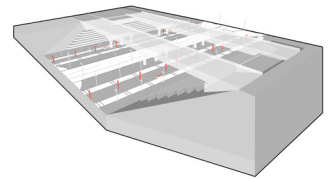

- Benches to encourage gathering
- Trail system that connects the entire site with the rest of the city
- Sculptures

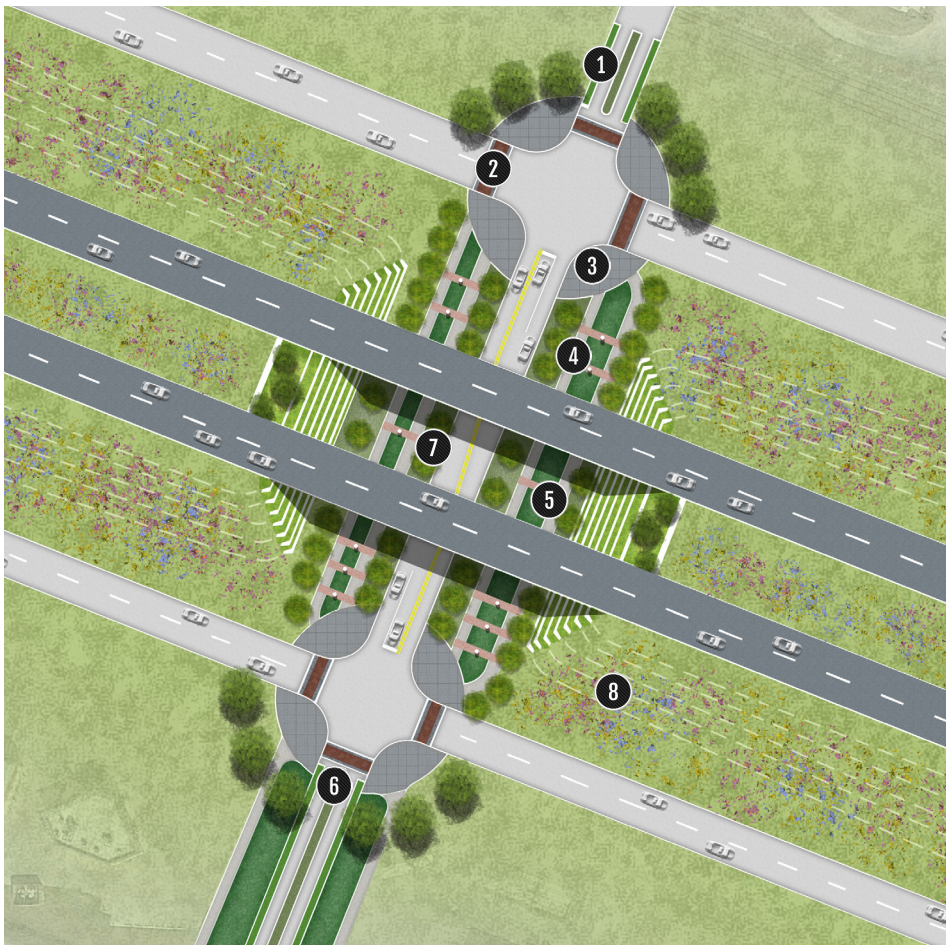

Legend

1. Bike Lanes



2. Brick Crosswalk



3. Concrete Safe Landing



4. Existing Sidewalk Turned Into Bike Lane



5. Proposed Pedestrian Sidewalk



6. Median proposed



7. Vertical Planters



8. Native Grasses





PATH SYSTEM THROUGH UNDERPASS AT PLANTERS



RESTING AREA AT BUTTERFLY ART PIECE